

<b>7560016</b>	ÖBB	Rh 1116	=		N
<b>7570016</b>			=	🔊	N

Pos. Nr. Pos.no.	Beschreibung Description	Art.-Nr. Art.no.	Preisgruppe Price bracket
1	GEHÄUSE O. PANTO. BETR.NR. 1116 181 Body ass. w/o panto.Loco no. 1116 181	107560016	35
2	TS - FÜHRERSTAND-LICHTLEITER Part set - Driver's cab - Light conductor	13781703	8
3	TS - STIRNFENSTER-SEITENFENSTER Part set - Front and side window	14781703	19
4	ISOLATOREN-SATZ Set of isolators	19731101	12
5	STIRNGRIFF Front handrail	197560016	6
6	HAUPTSCHALTER-ISOLATOR Mains switch, isolator	197311012	3
7	ISOLATOR Isolator	197311013	3
8	ISOLATOR Isolator	197311014	3
9	LEITUNG AM DACH Roof wiring	197311015	2
10	ARMATURENTEIL (UNTERFLUR) Fittings assy	33781705	12
11	MOTOR KPL.M.SCHWUNGMASSE Motor with flywheel, complete	50731212	31
12	KOHLHALTER Brush holder	00507801	1
13	MOTORDISTANZPLATTE,LED-ABDECK., Motor spacer plate, LED-cover,	50791600	9
14	LEITERPLATTE KPL. ANALOG PCB complete	65716400	28
15	BRÜCKENSTECKER Jumper	126404	9
16	EINHOLMSTROMABNEHMER Single arm pantograph	67703800	22
17	FK - SCHRAUBE M1,2x2,6 mm FK - Screw	70900005	2
18	ANTENNE LANG Antenna long	00197802	2
19	KOHLEBÜRSTE+FEDER Carbon brush+spring	133936	6
<b>Sound</b>			
20	LEITERPLATTE KPL. SOUND PCB complete	65716800	38
21	TS-LAUTSPRECHERHALTER Part set-Loudspeaker holder	687570016	12
22	LAUTSPRECHER Loudspeaker	68702500	16

Änderungen in Konstruktion und Ausführung vorbehalten  
We reserve the right to change the construction and specification

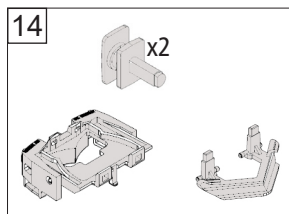
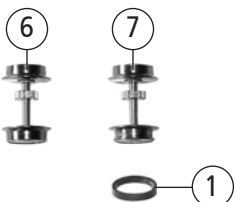
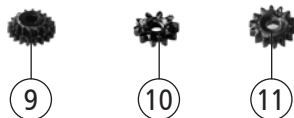
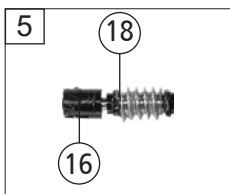
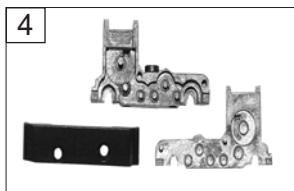
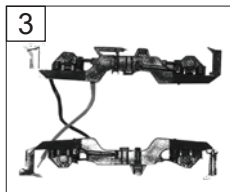
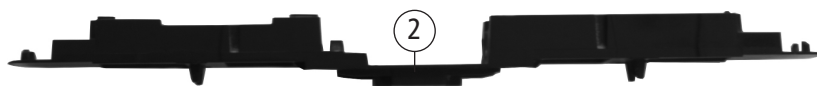

Pos. Nr. Pos.no.	Beschreibung Description	Art.-Nr. Art.no.	Preisgruppe Price bracket
7560016	ÖBB Rh 1116		N
7570016			N
1	HAFTREIFEN Traction tyre	00547002	1
2	LOKFAHRGESTELL O.MOTOR Loco chassis w/o motor	40731212	20
3	DREHGESTELLBLENDEN Bogie frames	41781303	14
4	GETRIEBE-SATZ 3-tlg. Gear set 3-piece	45731212	17
5	SCHNECKENBAUGRUPPE KPL. Worm gear assembly, complete	52731201	15
6	RADSATZ M. ZR O. HAFTRING Wheelset w.gear wheel w/o trac.tyre	53713900	15
7	RADSATZ M. ZR M. 1 HAFTRING Wheelset w.gear wheel w. 1trac.tyre	53714000	15
8	DEICHSEL Bogie	38801800	6
9	UNTERSETZUNGSRAD Z=14/19 Reduction gear wheel	56717700	6
10	ZAHNRAD Z=10 Gear wheel	56717800	3
11	ZAHNRAD Z=14 Gear wheel	56717900	3
12	GF - SCHRAUBE M1,6x4 mm GF - Screw	114850	3
13	Kupplung N-Spur Coupling	98189	6
14	TS - PUFFER,PUFFERBRUST Part set - Buffer, buffer beam	757560016	11
15	ZUGFEDER Draw spring	86208	3
16	KARDASCHALE F. SCHNECKENSATZ Cardan reception f. wormgear set	145585	3
17	ACHSLAGER N Axle bearing	145530	6
18	BEILAGSCHEIBE Washer	145804	4